

# APPLICATION FOR NON-PORTABLE SWIMMING POOL PERMIT

RECEIPT NO.  
\_\_\_\_\_

CITY OF HARPER WOODS  
19617 HARPER AVENUE  
HARPER WOODS, MI 48225  
313-343-2526

DATE FILED:  
\_\_\_\_\_

THE UNDERSIGNED HEREBY MAKES APPLICATION TO ERECT A NON-PORTABLE SWIMMING POOL. THE PERMIT FEE IS \$15.00 - WHICH FEE SHALL BE RETAINED BY THE CITY WHETHER OR NOT APPLICATION SHALL BE APPROVED AND THE PERMIT GRANTED. YOU WILL RECEIVE SIGNED APPLICATION UPON APPROVAL.

HOUSE NO. \_\_\_\_\_ STREET \_\_\_\_\_

LOT NO. \_\_\_\_\_ SUBDIVISION \_\_\_\_\_

IN ACCORDANCE WITH THE ACCOMPANYING PLANS AND SUBJECT TO ORDINANCES, RULES AND REGULATIONS COVERING THE CONSTRUCTION OF SWIMMING POOLS WITHIN THE LIMIT OF THE CITY OF HARPER WOODS.

OWNER'S NAME: \_\_\_\_\_

ADDRESS: \_\_\_\_\_

SIZE OF POOL (IN FEET): \_\_\_\_\_ x \_\_\_\_\_ SQUARE FEET: \_\_\_\_\_

DEPTH OF POOL: \_\_\_\_\_ GALLONS: \_\_\_\_\_

TYPE OF FILTER: \_\_\_\_\_ H.P.: \_\_\_\_\_

METHOD OF CHLORINATION OF THE WATER: \_\_\_\_\_ TESTING \_\_\_\_\_

SIZE OF LOT (IN FEET): \_\_\_\_\_ W x \_\_\_\_\_ D

FENCE TYPE: \_\_\_\_\_ HEIGHT (IN FEET): \_\_\_\_\_

TYPE OF LATCH AND LOCKS ON GATES AND DOORS LEADING TO POOL: \_\_\_\_\_

When approved by inspector and recorded, this is your non-portable permit.

APPROVED: \_\_\_\_\_

DENIED: \_\_\_\_\_

DATE: \_\_\_\_\_

INSPECTOR: \_\_\_\_\_

\_\_\_\_\_  
Signature of Applicant

\_\_\_\_\_  
Address

\_\_\_\_\_  
City & State

\_\_\_\_\_  
Phone Number

This non-portable pool permit is good for as long as you own your pool. If you purchase a new pool you must obtain a new permit.

**reverse side must also be completed**

Locate: Pool and all buildings on plot plan and complete the following:

Locate fence with x---x---x---x marks.

Draw lines locating all overhead wires and mark distance measured horizontally from pool edge.

From house service wires \_\_\_\_\_ feet.

From telephone line \_\_\_\_\_ feet.

From overhead easement wiring \_\_\_\_\_ feet.

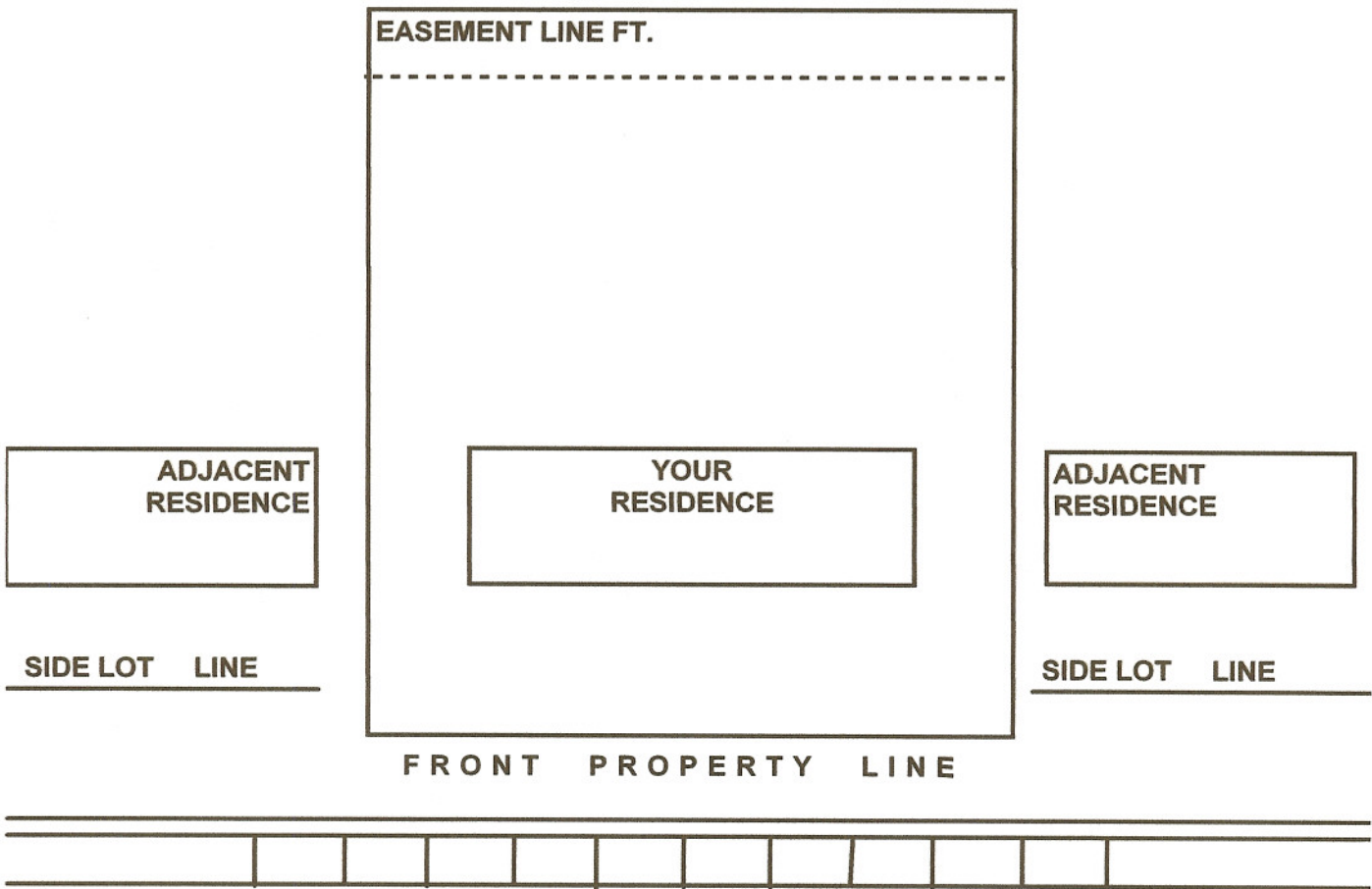

NAME OF STREET \_\_\_\_\_

PLEASE NOTE: ALL SERVICE WIRES MUST BE AT LEAST 10 FEET MEASURED HORIZONTALLY FROM THE EDGE OF THE POOL.